

DC-DC Astra
AS5R-xxSxxRC
AS5R-xxDxxRC



Wide Input Voltage Range 5 Watt Dc-Dc Converter

FEATURES:

2:1 Wide Input Voltage.

Recognized By UL 60950-1

Efficiency To 80%

PI Input Filter.

1500Vdc Isolation

MTBF:>1,500,000 hrs Operating Temperature:-40°C TO +85°C



Specifications typical at TA=25°C, nominal input voltage and rated output current unless otherwise specified

Part Number	Input Voltage	Output Voltage	Output Current	Efficiency
	Vdc	Vdc	mA	%TYP
AS5R-12S05RC	9-18	5	1000	75
AS5R-12S12RC	9-18	12	470	80
AS5R-12S15RC	9-18	15	400	80
AS5R-12D12RC	9-18	±12	±230	80
AS5R-12D15RC	9-18	±15	±190	80
AS5R-24S05RC	18-36	5	1000	75
AS5R-24S12RC	18-36	12	470	80
AS5R-24S15RC	18-36	15	400	80
AS5R-24D12RC	18-36	±12	±230	80
AS5R-24D15RC	18-36	±15	±190	80
AS5R-48S05RC	36-72	5	1000	80
AS5R-48S12RC	36-72	12	470	80
AS5R-48S15RC	36-72	15	400	80
AS5R-48D12RC	36-72	±12	±230	80
AS5R-48D15RC	36-72	±15	±190	80

Input Specifications

Parameters	Conditions	Min	Typ	Max	Units
Voltage Types				2:1	
Filter	Capacitor				

Output Specifications

Parameters	Conditions	Min	Typ	Max	Units
Voltage Tolerance				±2	%
Short Circuit Protection	Continuous				
Line Regulation				±0.5	%
Load Regulation	SINGLE			±0.5	%
Load Regulation	DUAL			±2.0	%
Ripple & Noise	BW=DC To 20MHz			100	mVp-p
Transient response setting time	50% load step change		350		us

General Specifications

Parameters	Conditions	Min	Typ	Max	Units
Isolation Resistance	500Vdc	1000			MΩ
Switching Frequency			200		KHz
Operating Temperature		-40		85	°C
Humidity	Non Condensing			95	%
Cooling	Free air Convection				
Case material	Nickel Coated With Non-Conductive Base or Black Coated Copper With Non-Conductive Base				
Weight			36.5		g
Dimensions			50.8x25.4x10.2		mm

Wide Input Voltage Range 5 Watt Dc-Dc Converter

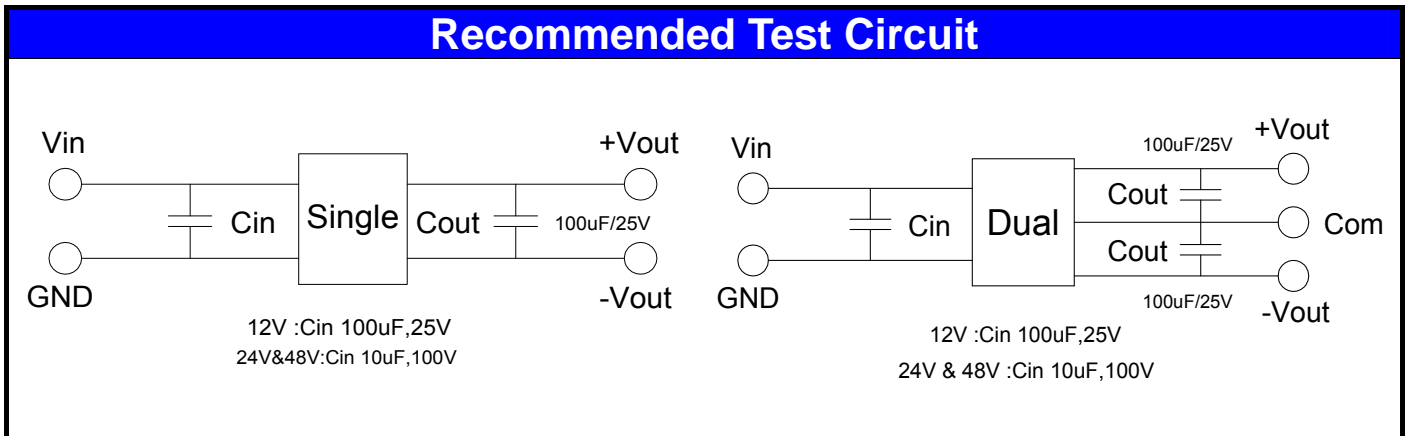
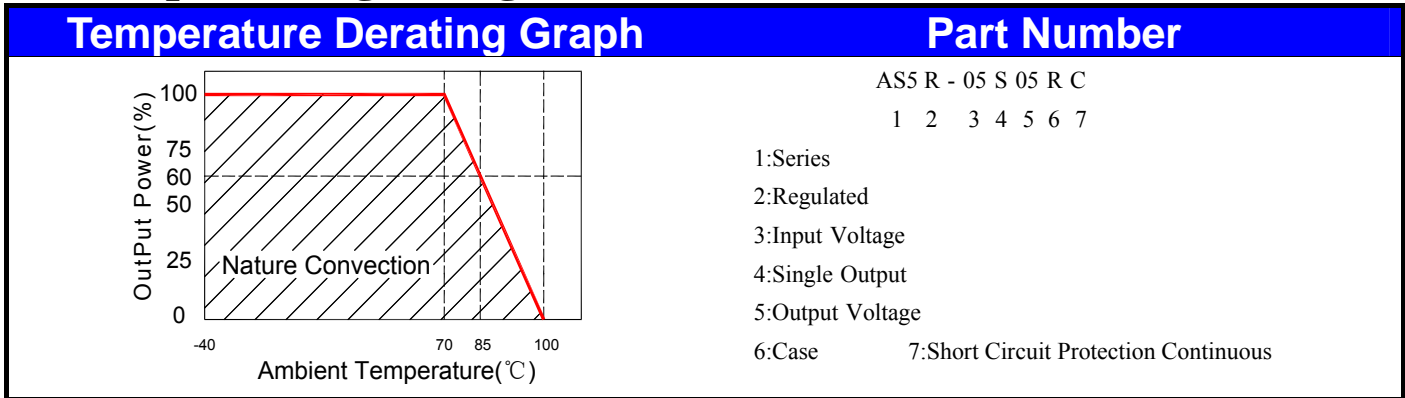

Markings and Dimensions Packaging

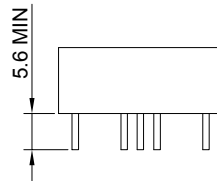
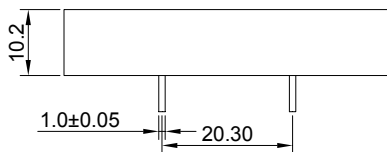
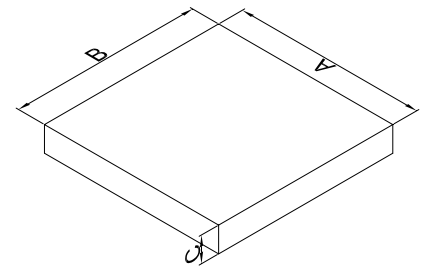
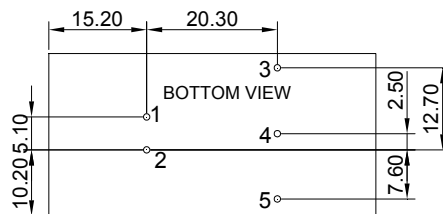
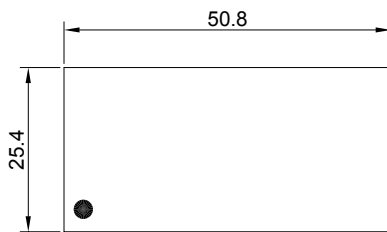

Size(mm)		
A	B	C
210.00	210.00	30.00

Unit : mm Unless otherwise specified, all tolerances are ±0.25

PIN Connection					
PIN	1	2	3	4	5
SINGLE	+Vin	-Vin	+Vout	NO PIN	-Vout
DUAL	+Vin	-Vin	+Vout	COM	-Vout