

DC-DC Astra AS1-xxSxxJK

AS1-xxDxxJK

1000Vdc Isolation Single & Dual Output 1 Watt Dc-Dc Converter

FEATURES:

14PIN DIL Package

High Efficiency up to 85%

Recognized By UL 60950-1

Internal SMD Construction

Unregulated Output Types No External Component Required

Operating Temperature:-40°C TO +85°C Industry Standard Pinout

ООО Компания "Элемент"



Specifications typical at TA=25°C, nominal input voltage and rated output current unless otherwise specified				
Part Number	Output Voltage	Output Current	Efficiency	Package Style
	Vdc	mA	%TYP	
AS1-XXS03J	3,3	303	70	1
AS1-XXS05J	5	200	70	1
AS1-XXS09J	9	112	75	1
AS1-XXS12J	12	84	78	1
AS1-XXS15J	15	67	80	1
AS1-XXS24J	24	42	82	1
AS1-XXD03J	±3.3	±150	70	1
AS1-XXD05J	±5	±100	70	1
AS1-XXD09J	±9	±56	75	1
AS1-XXD12J	±12	±42	78	1
AS1-XXS15J	±15	±34	80	1
AS1-XXD24J	±24	±21	82	1
AS1-XXS05K	5	200	70	2
AS1-XXS09K	9	112	75	2
AS1-XXS12K	12	84	78	2
AS1-XXS15K	15	67	80	2
AS1-XXS24K	24	42	82	2
AS1-XXD05K	±5	±100	70	2
AS1-XXD09K	±9	±56	75	2
AS1-XXD12K	±12	±42	78	2
AS1-XXD15K	±15	±34	80	2
AS1-XXD24K	±24	±21	82	2

Note: 1."XX" Is Input Voltage:03=3.3Vdc,05=5Vdc,09=9Vdc,12=12Vdc,15=15Vdc,24=24Vdc,48=48Vdc.

2. Over 48Vdc input voltage, using the K package.

3. The input voltage increases, there will be an increase in efficiency.

Input Specifications					
Parameters	Conditions	Min	Typ	Max	Units
Voltage Tolerance	Vo,lo Nom			±10	%
Filter	Capacitor				

Output Specifications					
Parameters	Conditions	Min	Typ	Max	Units
Voltage Tolerance	100% full load			±5	%
Short Circuit Protection	Short Term			1Sec	
Line Regulation	For 1.0% OF Vin		1.2		%
Load Regulation	3.3V,5V(10% To 100% F.L)			15	%
Load Regulation	9V,12V,15V,24V(10% To 100% F.L)			10	%
Ripple & Noise	BW=DC To 20MHz			100	mVp-p
Transient response setting time	50% load step change		350		us

General Specifications					
Parameters	Conditions	Min	Typ	Max	Units
Isolation Resistance	500Vdc	1000			MΩ
Switching Frequency	Full load,nominal input		100		KHz
Operating Temperature		-40		+85	°C
Humidity	Non Condensing			95	%
Cooling	Free air Convection				
Case material	DAP				
MTBF	MIL-HDBK-217F@25°C	3500000			Hours
Weight	Package 1 or Package 2		2.3 or 2.8		g
Dimensions	Package J		20.32x10.16x6.80		mm
Dimensions	Package K		20.32x10.16x7.70		mm

ООО Компания "Элемент"

г.Новосибирск, ул.Некрасова д.50 оф.902

www.astra-power.ru

тел. (383)233-77-25, 233-77-26

моб.тел. 8-913-95-95-400

DC-DC Astra
AS1-xxSxxJK
AS1-xxDxxJK

ООО Компания "Элемент"



1000Vdc Isolation Single & Dual Output 1 Watt Dc-Dc Converter

Temperature Derating Graph

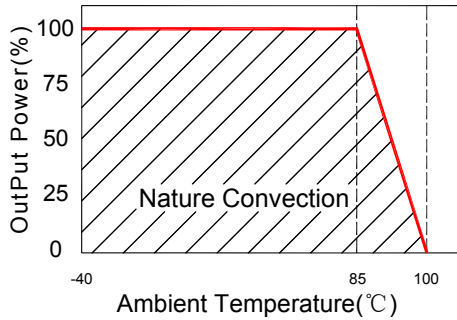

Tolerance Envelope Graph

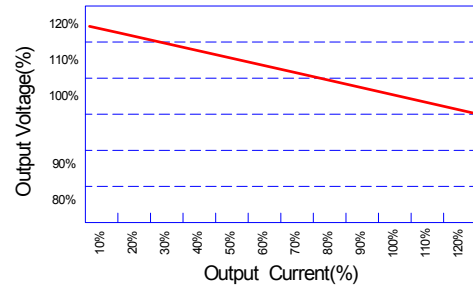

Recommended Test Circuit

Part Number

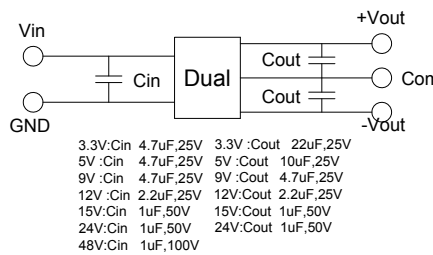
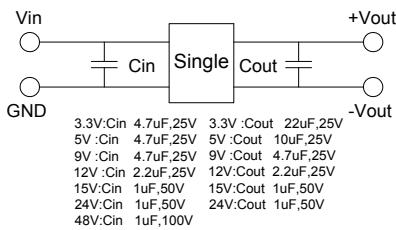

AS1 - 05 D 05 J K
 1 2 3 4 5 6

- 1:Series
- 2:Input Voltage
- 3:Output
- 4:Output voltage
- 5:Case J 20.32x10.16x6.80
- 6 Case K 20.32x10.16x7.70 .

Markings and dimensions

J.

K.

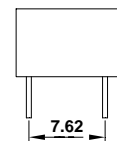
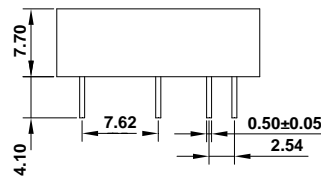
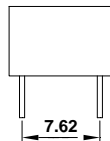
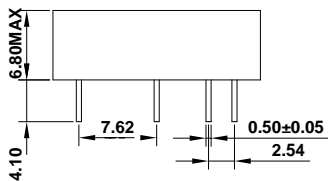
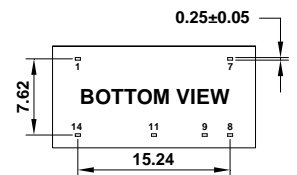
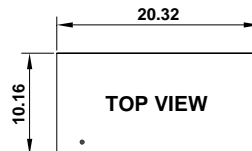
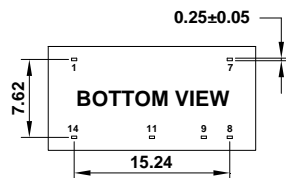
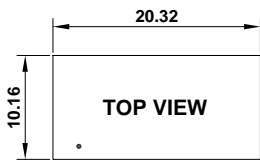

Unit: mm Unless otherwise specified, all tolerances are ± 0.25

PIN Connection

PIN	1	7	8	9	11	14
Single	-Vin	NC	-Vout	+Vout	NC	+Vin
Dual	-Vin	NC	COM	+Vout	-Vout	+Vin